

1



2



3

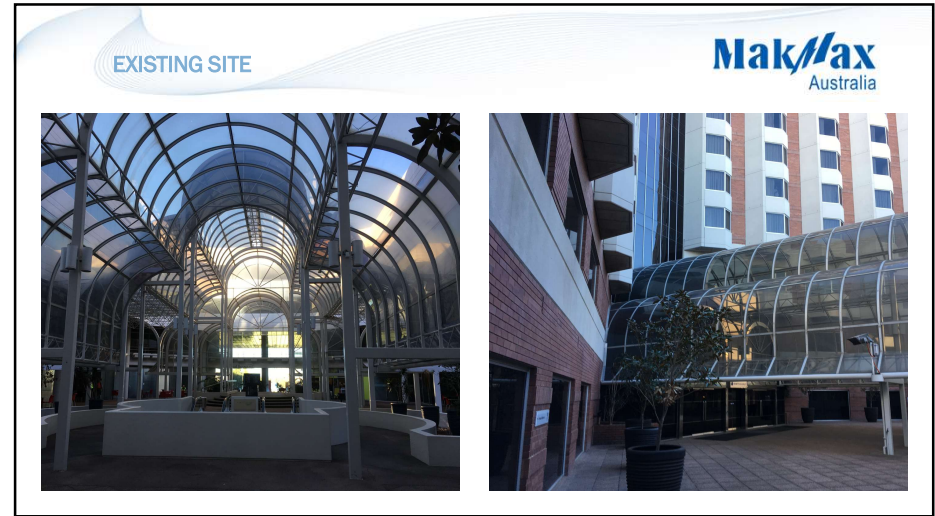

4



5

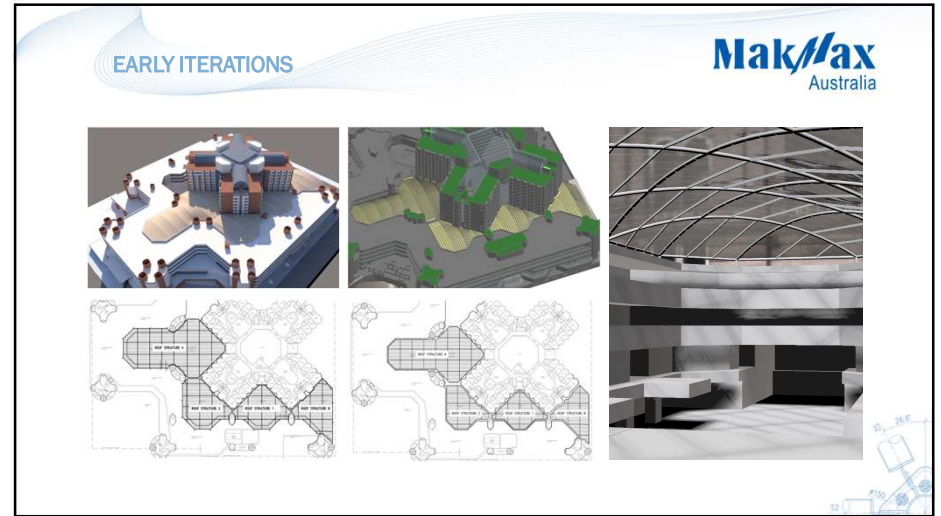

6

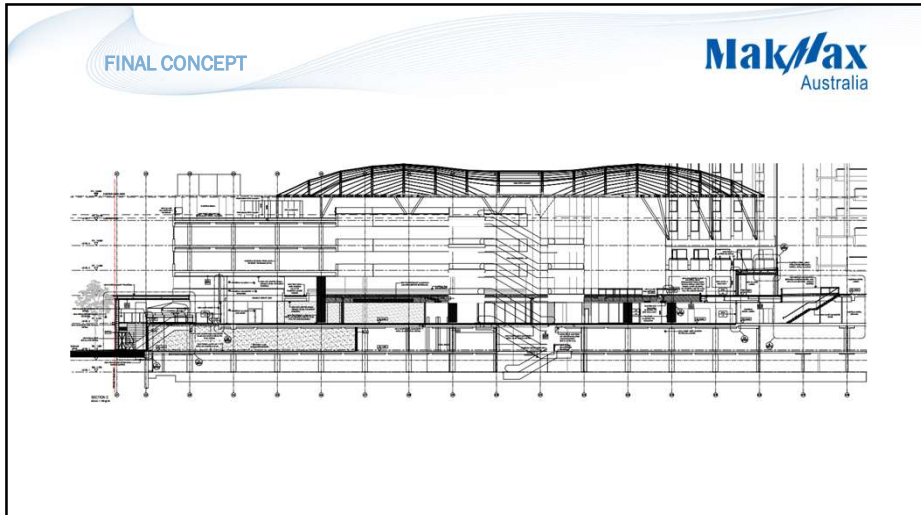

7

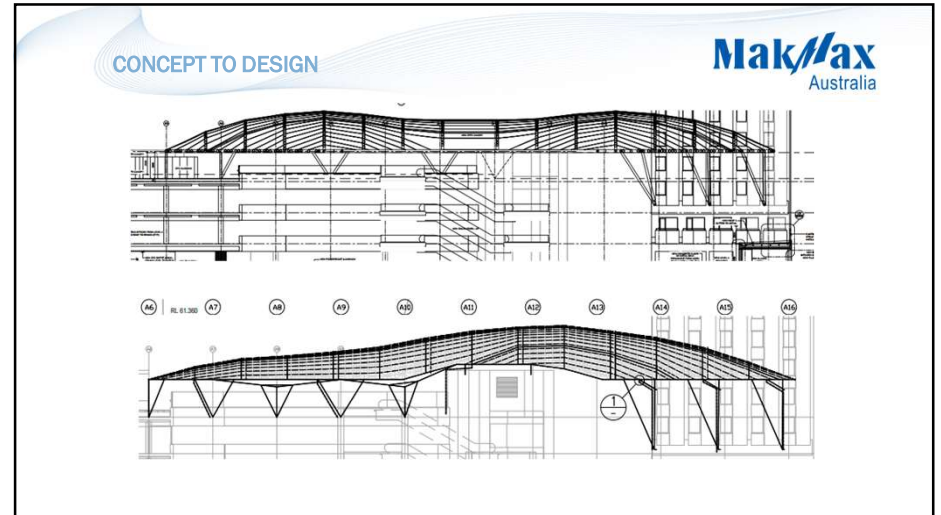

8

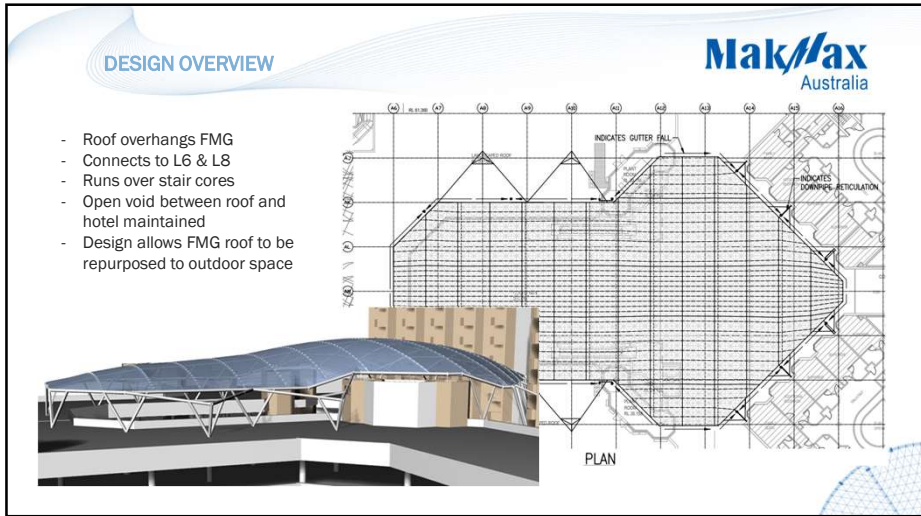

9

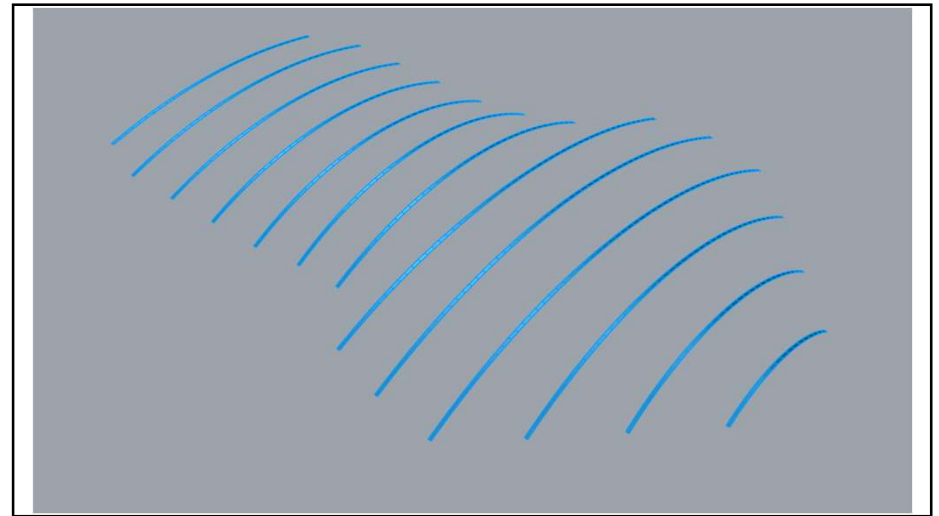

10

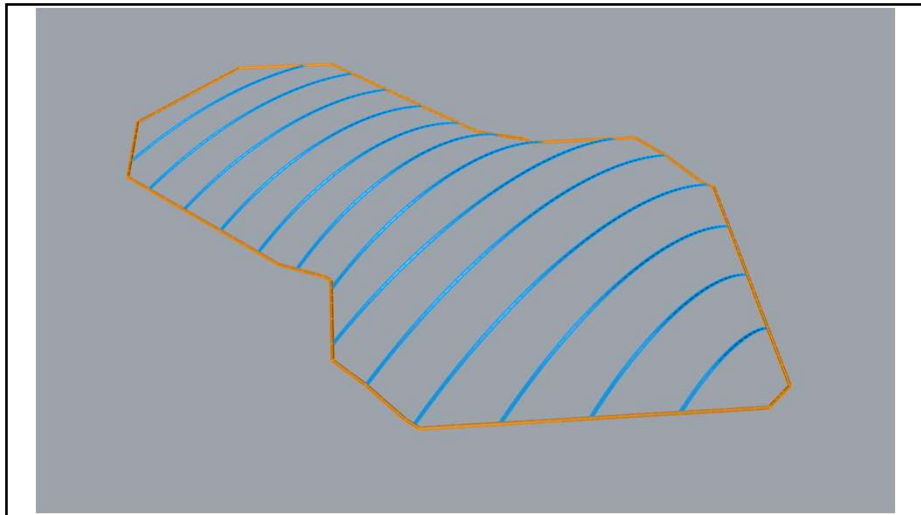

11

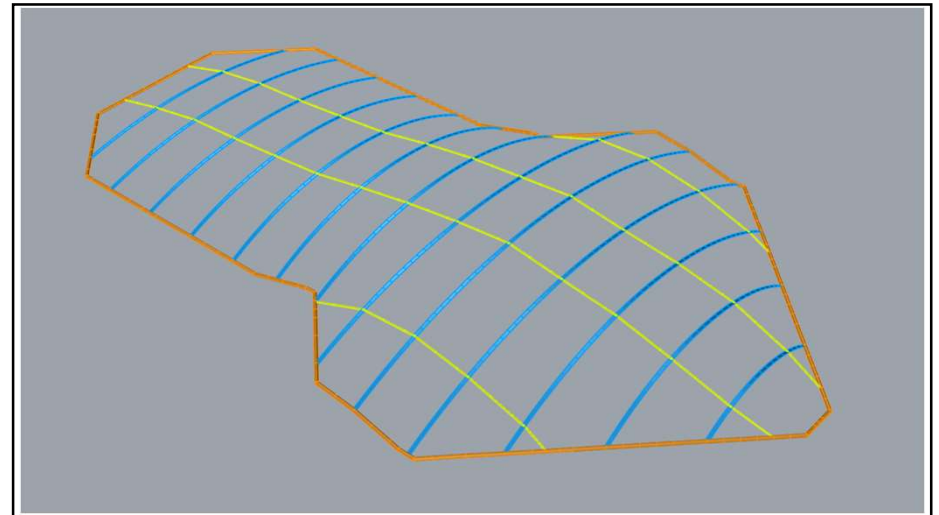

12

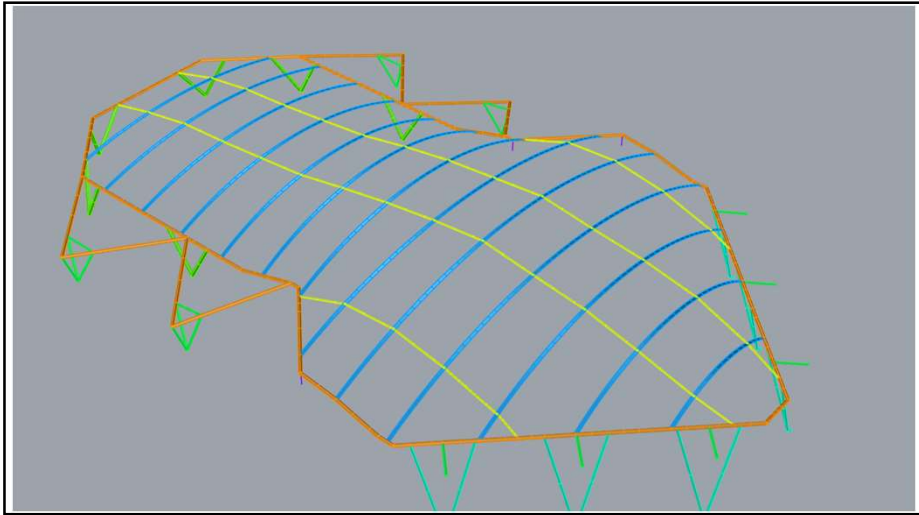

13

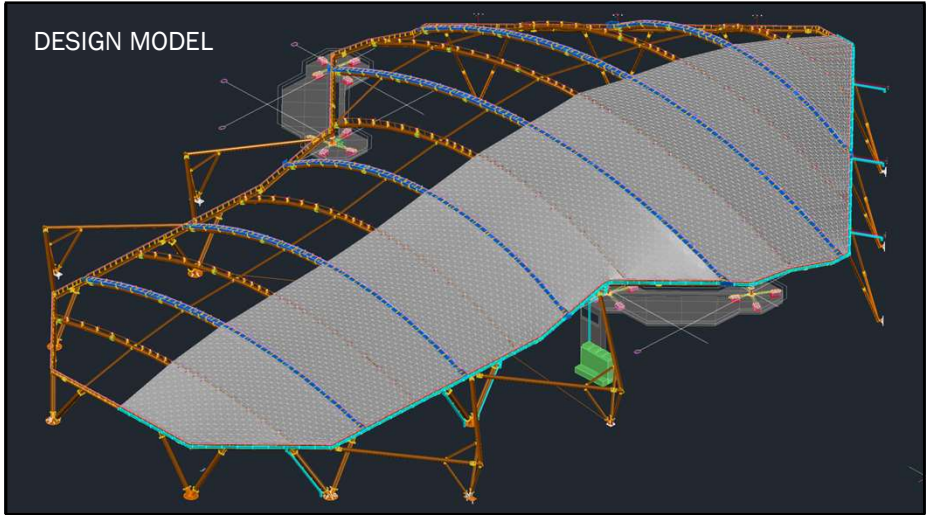

14

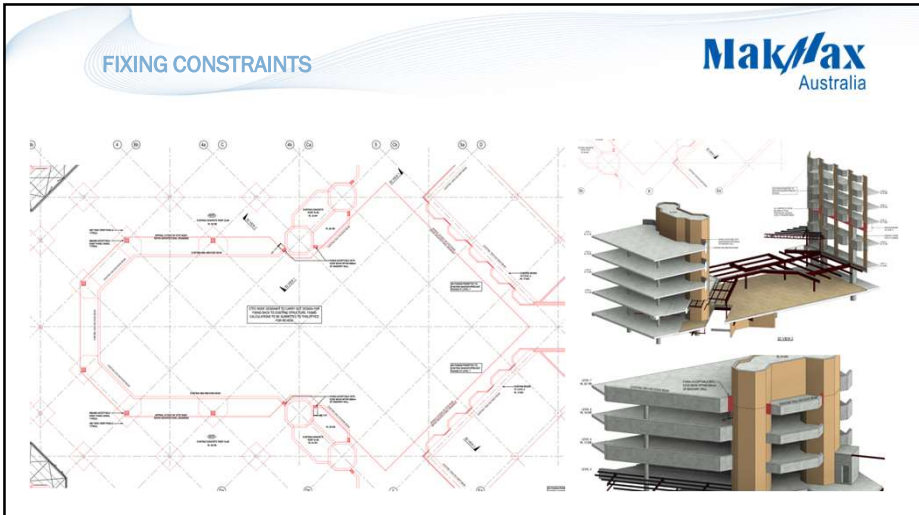

15

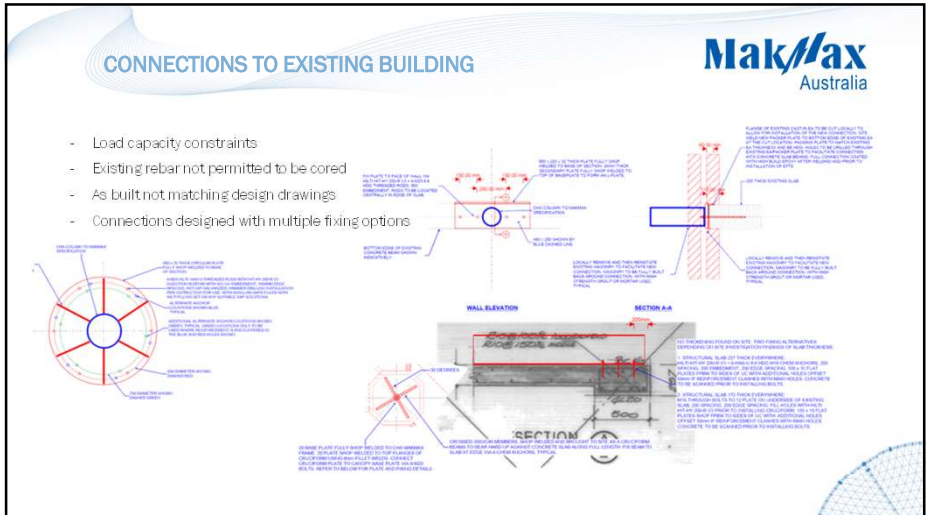

16

MakMax
Australia

CONNECTIONS TO EXISTING BUILDING

17

MakMax
Australia

CONNECTIONS TO EXISTING BUILDING

- Existing rebar clashes extensive
- Variances between in-situ and design also high
- Original plan to fabricate to surveyed anchors changed to match drill base plates on site

18

MakMax
Australia

DRAINAGE & PONDING

- Intermittent rafters with a gutter
- Full perimeter gutters
- Downpipes coordinated with hotel
- Steep gutter falls in some areas
- DP location drove gutter sizing
- Roof quite flat in central third
- Cable spacing doubled

19

MakMax
Australia

DRAINAGE & PONDING

20



21

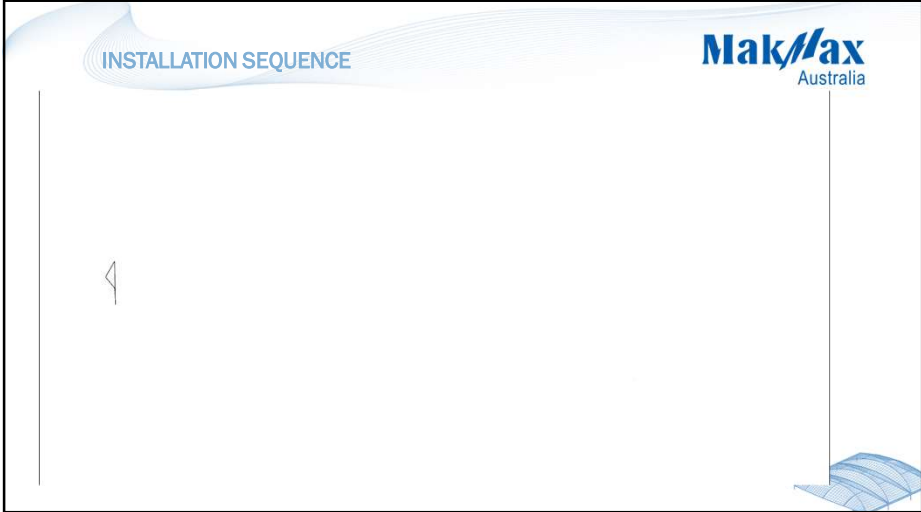

22



23



24



25



26



27



28



29



30



31



32

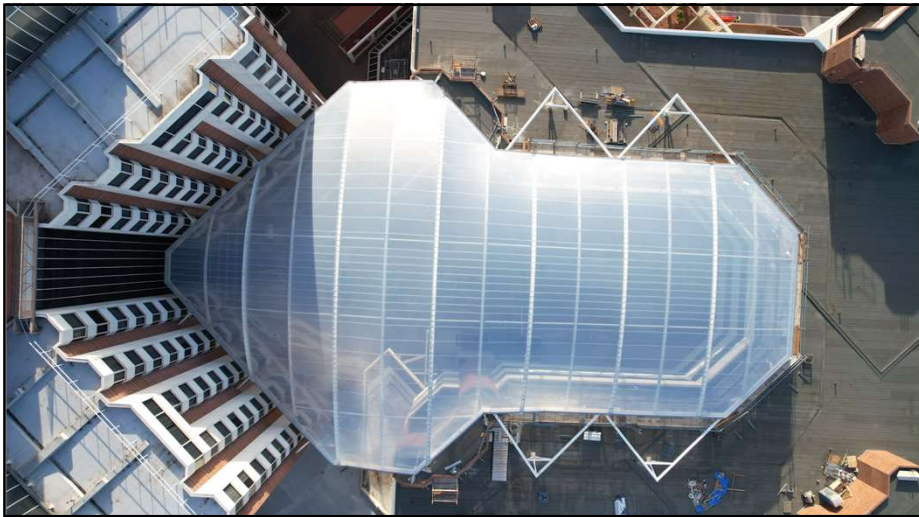

33



34

 A photograph showing the interior of a large stadium with a white, geodesic dome. The stadium is filled with blue seats, and the field is visible in the center. The sky is clear and blue.

MakMax
Australia

Design. Engineer. Fabricate. Install.

MakMax Australia
1300 625 629 | info@makmax.com.au | www.makmax.com.au

35